

**WEON**™

## SUB WOOFER AMPLIFIER SYSTEM

MODEL No. HTAS - 2250

### QUICK GUIDE

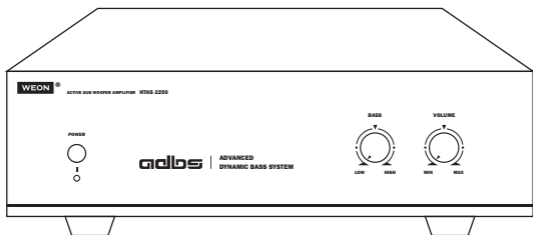

---

Please read all instructions carefully before operation  
to obtain the best performance from the unit

---

<b>Points to note</b> .....	03
<b>Precautions</b> .....	03
<b>Controls &amp; Connectors</b> .....	04
<b>Description of functions</b> .....	04
<b>Multiple ways to connect</b> .....	05
Using RCA Level Input .....	05
Using Speaker Level Input .....	05
Using an External Source .....	06
<b>TIPS for best results</b> .....	06
<b>Getting started</b> .....	07
Power On .....	07
Bass Setup .....	07
<b>Box Positioning</b> .....	08
<b>About LED Light</b> .....	08
<b>Heating</b> .....	08
<b>Trouble Shooting</b> .....	09
<b>Maintenance</b> .....	09
<b>Specifications</b> .....	10
<b>Contact Us</b> .....	10

---

**WARNING****WEON**™

WEON is a Registered Trade Mark Brand under Indian Trademark Organization, Misuse of our brand, copying our product is illegal and may commence legal actions under the trademarks act, 1999.

---

**For Your Satisfaction**

Check the entire unit for any damage or crack / broken damages, If any thing of such errors found, Kindly Ask for a replacement, Your product is eligible for a free replacement in such cases with in 7 days and being under warranty for upto 6 Months

**To Claim the Warranty**

It' important to Register your product with in 30 days of purchase, You have to show up the warranty card along with the unit when warranty service required, So, it's advisable to keep the warranty card in a Best & safest place

**On Re Packing**

Do not throw away the carton and the packing material, It makes an ideal container to transport the unit in. When shipping the unit for repair work or to another location, Re pack it with the carton box

**On Maintenance**

Clean the cabinet, panel and controls with a soft cloth lightly moistened with mild detergent solution. Do not use any type of abrasive pad, scouring powder or solvent such as alcohol or benzine

**Attention !**

Don't tear the warranty sticker and avoid repair the unit by yourself ever, Doing so will void the warranty, No claims will be accepted there offer

**On Safety**

Should any liquid or solid object fall into the cabinet, Unplug the unit and have it checked by qualified personnel before operating it any further, Unplug the unit from the wall outlet, If the unit is not to be used for an extended period of time, To disconnect the cord - pull it out by grasping the plug, Never pull the cord itself.

**On installation**

Do not install the unit in location near heat sources, Or in a place subject to direct sunlight, excessive dust, mechanical vibration or shock.

Place the unit in the location with adequate air circulation.

DO not place anything on top of the cabinet.

The top ventilation holes must be unobstructed for proper operation of the unit and to prolong the life of its components.

To reduce the risk of fire or electric shock, do not expose this appliance to dripping or splashing, and do not place objects filled with liquids such as vases, on the appliance

**On POWER Sources**

The unit is not disconnected from the mains as long as it is connected to the AC outlt, even if the unit itself has been turned off

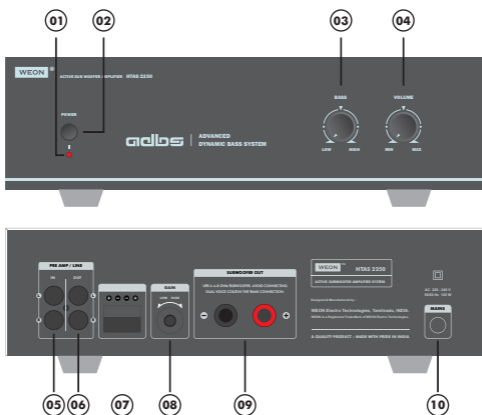

## DESCRIPTION OF FUNCTIONS

### 01. Status LED

This LED is used to show up the status of the Amplifier while playing, Glows in Green Color in Normal Condition, Shows in RED color when any Error Occured, Please read In About LED light page for Details

### 02. Power Switch

To power on or off the unit

### 03. Bass Control

To adjust the bass level as per your taste

### 04. Volume Control

To adjust the required sound output level

### 05. RCA Level Inputs

Used to connect by pre amp / line out method

### 06. RCA Level Outputs

Used to connect by pre amp / line out method

### 07. Speaker level Inputs

Used to connect if the source music system doesn't has the line out

### 08. Speaker level Outputs

Used to connect if the source music system doesn't has the line out

### 09. Woofer Output

Used to connect passive woofer

### 10. Main AC Cord

To connect with the AC outlet

To enjoy the bass effect you need to provide an input signal and a sub woofer which is fixed on a well constructed enclosure, Your AV receiver or music amplifier is the source signal for HTAS - 2250 sub woofer bass amplifier, it will work with both stereo and or mono signals as well, You can connect your HTAS - 2250 Subwoofer Amplifier in 3 ways like RCA Line level input, Speaker level input & Using External Audio Device

## USING RCA LEVEL INPUTS

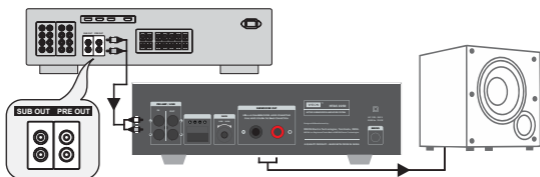

Take a good quality of 2 RCA to 2 RCA cable to connect one end to your source unit's signal output and other end goes to signal input of sub woofer amplifier, Please refer the image shown above for easy understanding

## USING SPEAKER LEVEL INPUT

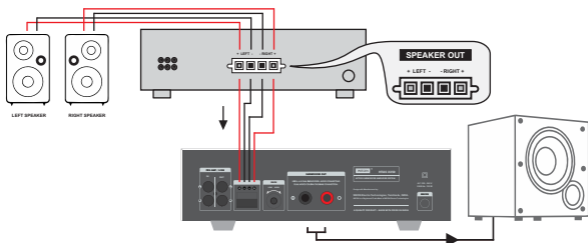

Take a small piece of two-strand wire and join it to the speaker wires. Connect the other end of the wires with the supplied connector with correct polarity. Insert the connector into the speaker-level input of the subwoofer amplifier, as illustrated in the image above.

If you wish to connect an audio device from external source like I pod or cell phone by using an Aux cable with both the music amplifier and sub woofer amplifier, please follow up the instructions provided below..

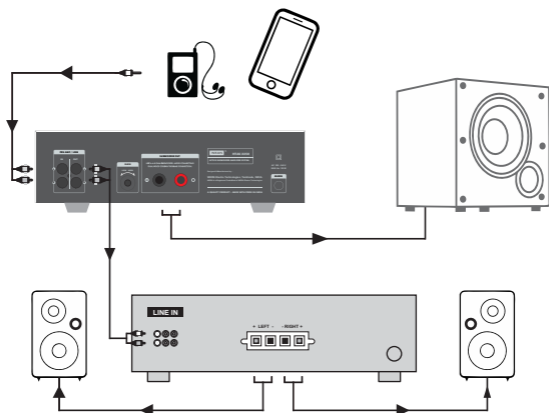

feed the output signal of the external source to RCA line input of the sub woofer amplifier, Then take the output signal from sub woofer amplifier to connect with your music amplifier's input, Please refer the above image for clarification if needed

## TIPS FOR BEST RESULTS

Most of the AV Receivers / Music Amplifiers have the Pre amp / Line Output ports, The signal coming from this outputs are authentic from the content which is not modified with low, mid & high frequency adjustments in any way, So Connecting Your HTAS - 2250 Subwoofer Amplifier with this signal is recommended.

If you feel a distorted or over bass when connecting with speaker level input - please **reduce the gain** control in the back of the subwoofer amplifier for best result.

In other case, If you are using a cell phone as an input, **maximize the gain** control for optimum audio performance.

**POWER ON**

Plug your sub woofer's AC cord into a wall outlet. Do not use the outlets on the back of the receiver. Initially set the Sub woofer Volume Control ( 04 ) to the "MIN" position. Turn on the sub woofer by pressing the Power Switch ( 02 ) on the front panel. Turn on your entire audio system and start a CD or movie soundtrack at a moderate level.

If no sound emanates from the sub woofer, check the AC-line cord and input cables. Are the connectors on the cables making proper contact? Is the AC plug connected to a "live" receptacle? Has the Power Switch ( 02 ) been pressed to the "On" position? Once you have confirmed that the sub woofer is active, proceed by playing a CD or DVD. Use a selection that has ample bass information.

Have you noticed ? your Sub woofer amplifier comes with delay on protection mode, The HTAS - 2250 sub woofer amplifier will play the bass only after a few seconds each time you power on, This is a special feature to protect your sub woofer from a peak power that comes when switched on the unit, Read more about the dual protection feature in the About LED Light page

**SUGGESTION**

We recommend that you do not operate your sub woofer amplifier HTAS - 2250 with full boost. This will place undue strain on your electronics and speakers and could damage them.

**BASS SET UP**

Set the overall volume control of the Receiver / Processor to a comfortable level. Adjust the Sub woofer Volume Control ( 04 ) until you obtain a pleasing blend of bass.

It is important that you make the some adjustments to both of the loud speakers and your sub woofer. While the music is playing, sit in your favorite chair and have somebody else to slowly adjust the Bass control from fully clockwise to fully counter-clockwise. At a certain frequency, you should hear the problem lessen and the overall bass performance improve. When you are satisfied that you have found the best frequency, have your assistant vary the Levels slowly up and down until you have maximized the improvement. The entire process will takes less than 10 minutes.

Kindly note that, The Bass response should not overpower the room but rather be adjusted so there is a harmonious blend across the entire musical range.

Many users have a tendency to set the sub woofer volume too loud, adhering to the belief that a sub woofer is there to produce lots of bass. This is not entirely true. A sub woofer is there to enhance bass, extending the response of the entire system so the bass can be felt as well as heard. However, overall balance must be maintained or the music will not sound natural. An experienced listener will set the volume of the sub woofer so its impact on bass response is always there but never obtrusive.

Well, After correctly connecting the HTAS - 2250 system and verifying that both the sub woofer and all satellite speakers are playing, it is time to optimize the entire system for your particular listening room.

Earlier, you placed the sub woofer speaker in it's general location, Finding the exact location for optimum performance some times only involves moving the sub woofer speaker box up to a few inches in any direction. We urge you, therefore, to experiment with the placement of sub woofer, if possible, until your sub woofer deliver it's full potential..

## **ABOUT LED LIGHT**

Your Sub woofer amplifier has in build dual protection mode against delay on & any internal error in the amplifier, usually the status LED will lights up in RED for a few seconds when power on the unit, after few seconds the LED will Stands up in GREEN colour, Which means the system is working in all normal conditions,

The LED becomes back in RED color in two different criteria,

1) Any internal error in amplifier makes the LED into permanently RED color , if the LED doesn't turn to green color for more than 10 seconds, its indicated that your sub woofer amplifier needs service , But it gives you an alert signal before the unit become dmaged

2) Whenever the amplifier reached it's full peak power and a clipped output, in this stage RED color will show up only a few second, then turned into green, The led will blink in red & green in an untimely interval, if used contentiously. This is an alert signal for an error, You are advised to reduce the volume level and or bass level adjustment, if not - the amplifier becomes dead in the next few seconds and you will see the LED showing only in RED color.

## **HEATING**

All types of audio systems are become hot after some time, it's an usual procedure, Hence, No need to panic, However the heat should not become more than a particular level,

If you feel too much of heat is generated on the Body of the Amplifier, check your sub woofer's Impedance, it should not be lower than 4 Ohms, Remove one pair of wires in dual voice coil type sub woofer, if used. Kindly check the woofer wire for any short connection or internally touched with each other or touched with the chassis, Do not operate the amplifier in UPS and or a power genset, doing so may be a reason for the heating issue

We suggest you to do not run your sub woofer amplifier system continously for a long time, Giving a break will help to reduce the heating issue and help to extend the life of your sub woofer amplifier



If you are experiencing any of the following difficulties while using the system, Use this trouble shooting guide to help remedy the problem before requesting repair or service, Should any problem persists, Contact us, We will provide you the necessary steps further...

**NO SOUND from woofer**, Please check

Receiver / Amplifier is Power ON and Source is playing  
HTAS - 2250 Sub woofer Amplifier is in ON Position  
Check all connection of your Receiver / Amplifier and Speakers,  
Make sure all wires are connected,  
None of the Speaker wires are cut or punctured,

**Low bass output**

Make sure the connections to the Left and Right  
"Speaker Level Inputs" have the correct polarity (+ & - )

**Unit is ON, But RED Light glows,**

Make sure the Woofer & Speaker wires are  
not touched with the chassis, and each other,

**Unit becomes very hot**

Improper load of Woofer, Connect a woofer rated  
4 Ohms 100 Watts Minimum

**BASS Punching is not up to the mark**

Try with other type of woofer enclosure, Re position or  
Re locate the sub woofer box,

**If still problem continues..**

Call our Customer support team immediately

**MAINTENANCE**

The sub woofer amplifier HTAS - 2250 may be cleaned using a soft cloth to remove fingerprints or to wipe off dust. All wiring connections should be inspected and cleaned or remade periodically. The frequency of maintenance depends on the metals involved in the atmospheric conditions and other factors, but once per year is the minimum.

If a problem occurs, make sure that all connections are properly made and clean. If a problem exists in the woofer speaker - reverse the connection wires. If the problem remains, then the fault is with the sub woofer speaker. In the event that your HTAS - 2250 ever needs service, Don't hesitate to contact us on our customer care service.

**IMPORTANT**

**Whenever changing cables, Pulling Plugs, etc., It's very important to  
TURN OFF ALL EQUIPMENT, Including sub woofer amplifier for your safety.**

<b>GENERAL</b>	Model No.	HTAS - 2250
	Working Voltage	AC 220 -240 V @ 50 - 60 Hz
	Max. Power Conception	100 W
	Dimension ( W D H )	28 X 20 X 9.1 CM
	Weight	4.0 Kg

<b>AUDIO</b>	Max. Power Output	250 W
	Full Bandwidth Power	180 W
	Speaker Impedance	4 Ohms
	Frequency Responce	20 - 450 Hz
	Max. Input Voltage	1.200 mV
	Input Impedance	20 k Ohms
	THD @ 1 KHz	< 0.001 Hz

We are continually strives to update and improve existing products, as well as create new ones. The specifications and construction details may subject to change without prior notice.

**CONTACT US..****WEON Electro Technologies**

Customer Support : +91 890 340 9009

Technical Support : +91 890 345 66 77

( Mon - Sat, 10.00 am to 7.00 pm )

mail : [customer.care.weon.india@gmail.com](mailto:customer.care.weon.india@gmail.com)

Find Us on GOOGLE : WEON Electro Technologies

[www.weon-india.com](http://www.weon-india.com)